

SmartBright Dual_Select Panel RC170B LED Panel

Mounting Instruction

V1.0

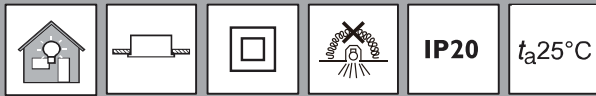

Product Type	CCT (K)	Power (W)	Lumen Output (lm)	Voltage	Frequency	Dimension / LxW (mm)	Dimension / H (mm)	Dimension / H1 (mm)	kg
RC170B LED31_37_41/SCCT PSU W30L120 GM	4000K 5000K 6500K (Selectable)	26/31/34W (Selectable)	3100/3700/4100lm (Selectable)	220-240V~	50/60Hz	1195x295	34	59	1.44
RC170B LED31_37_41/SCCT PSU W60L60 GM						595x595	34	59	1.38
RC170B LED40_45_50/SCCT PSU W60L120 GM						1195x595	34	59	3.85

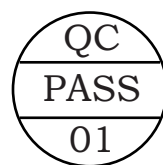
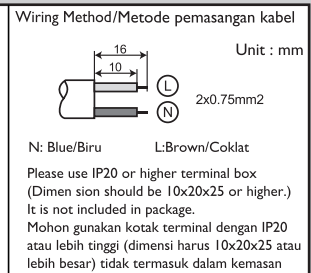
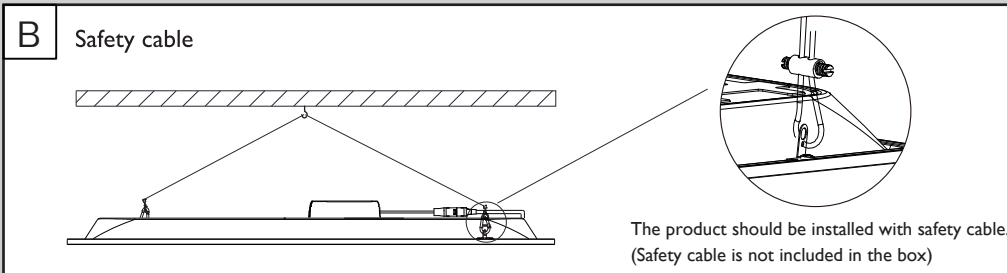
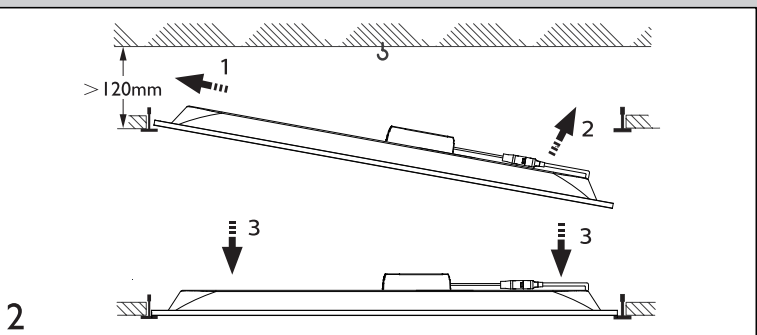
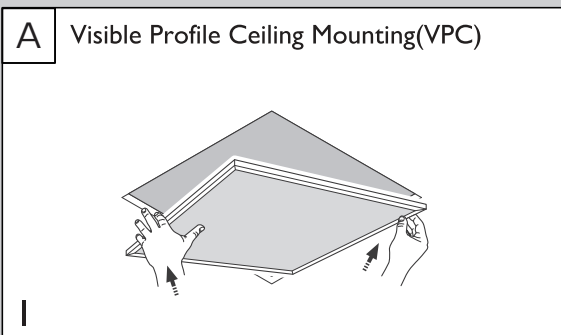
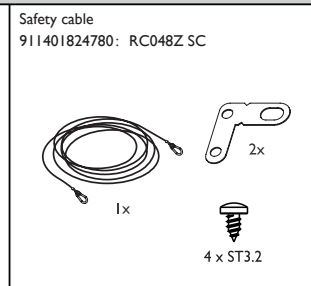
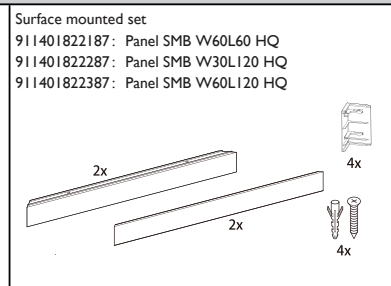
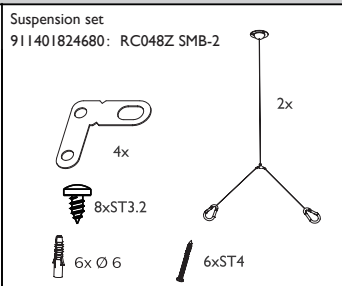
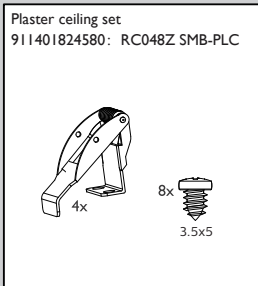
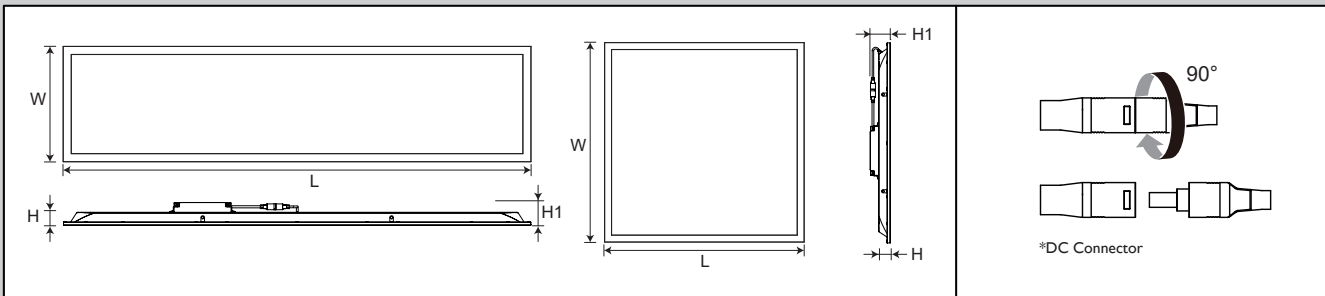

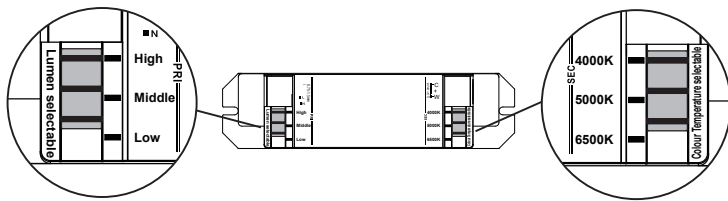

6060 30120	Lumen selectable	Lumen	Wattage	Iout
	High	4100lm	34W	900mA
	Middle	3700lm	31W	850mA
	Low	3100lm	26W	750mA

60120	Lumen selectable	Lumen	Wattage	Iout
	High	5000lm	38W	800mA
	Middle	4500lm	34W	720mA
	Low	4000lm	30W	640mA

Model	Run Current (A) (@230V)	Start (Inrush) Current(A) / Ipeak (A)	Start Current Duration (μs) / T(@50% of Ipeak) (μs)	* Touch current or protective conductor current (mA)	Maximum Number of Luminaire on MCB 16A Type B (pcs)	Maximum Number of Luminaire on MCB 16A Type C (pcs)
RC170B LED31_37_41/SCCT PSU W30L120 GM	0.21	30	300	< 0.7	13	23
RC170B LED31_37_41/SCCT PSU W60L60 GM	0.21	30	300		13	23
RC170B LED40_45_50/SCCT PSU W60L120 GM	0.21	30	300		14	25

The leakage current *(touch current or protective conductor current) of electrical circuit may be greatly dependent upon electrical supply cables used such as its rating and length, proper connection of electrical supply cables to luminaires and wiring connection topology of luminaires to the supply electrical circuit amongst other site conditions.
 * In some cases referred to as Earth Leakage Current.

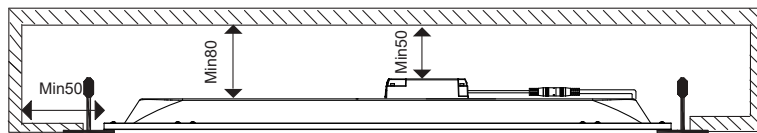

Unit: mm

Please read this manual carefully before using the product.

1. For indoor use only.
2. Do not switch on before complete installation.
3. The luminaire shall be installed by a qualified electrician and wired in accordance with the latest IEE electrical regulations or the national requirements.
4. The light source of this luminaire is not replaceable; when the light source reaches its end of life the whole luminaire shall be replaced.
5. Luminaire must not be used or stored in corrosive environment where hazardous materials such as Sulphur, Chlorine, phthalates, etc, are present.
6. Risk of overheating or fire if the clearance distances are compromised.
7. Care should be taken at installation to allow adequate air flow for optimum lifetime performance.



This marking indicates that this product should not be disposed with other household wastes throughout the EU. To prevent possible harm to the environment or human health from uncontrolled waste disposal, recycle it responsibly to promote the sustainable reuse of material resources. To return your used device, please use the return and collection systems or contact the retailer where the product was purchased. They can take this product for environmental safe recycling.



Luminaire is not suitable for application covering with thermally insulating material