



# Essential Smartbright Projector Gen 2

ST033T LED17/830 20W 110-240V I MB WH HK

Collimator with focus angle 24° -

Essential SmartBright Projector ST033T is a value for money product designed for Mass market trade. It is designed to replace halogen and CDM-standard-based projectors for retail and hospitality applications. This track based luminaire supports retailers to let their products stand out, or highlight certain objects. The clean and contemporary design with integrated driver, and choice in 24 or 36 degree beam angle makes the Essential SmartBright Projector relevant to many applications. The choice of 2 colors in White and Black helps the Retailer to choose products best suited to blend into the Store Environment.; Compared to it's predecessor, it is not only cost effective, but also a more sleek and lighter product design. The product family includes 1M and 2M Track in Black and white color with I and L connector to support various applications.

## Product data

General information		Operating and electrical	
Light source color	830 warm white	Input Voltage	110 to 240 V
Optical cover/lens type	Collimator with focus angle 24°	Input Frequency	50 or 60 Hz
Control interface	-	Inrush current	8.2 A
Protection class IEC	Safety class II	Power Factor (Min)	0.9
Flammability mark	For mounting on normally flammable surfaces	Controls and dimming	
CE mark	-	Dimmable	No
Number of products on MCB of 16 A type B	73	Mechanical and housing	
Light source engine type	LED	Housing Material	Aluminum

## Essential Smartbright Projector Gen 2

Optical cover/lens material	Polycarbonate
Optical cover/lens finish	Textured
Overall length	215 mm
Overall width	155 mm
Overall height	65 mm
Overall diameter	65 mm
Color	White

### Approval and application

Ingress protection code	IP20 [ Finger-protected]
Mech. impact protection code	IK03 [ 0.3 J]

### Initial performance (IEC compliant)

Initial luminous flux (system flux)	1600 lm
Luminous flux tolerance	+/-10%
Initial LED luminaire efficacy	80 lm/W
Init. Corr. Color Temperature	3000 K
Init. Color Rendering Index	>80
Initial chromaticity	(0.4338, 0.4030) SDCM <5

Initial input power	20 W
Power consumption tolerance	+/-10%

### Application conditions

Ambient temperature range	-20 to +45 °C
---------------------------	---------------

### Product data

Full product code	871951495946099
Order product name	ST033T LED17/830 20W 110-240V I MB WH HK
EAN/UPC - Product	8719514959460
Order code	911401882284
Numerator - Quantity Per Pack	1
Numerator - Packs per outer box	30
Material Nr. (12NC)	911401882284
Net Weight (Piece)	0.279 kg



## Dimensional drawing

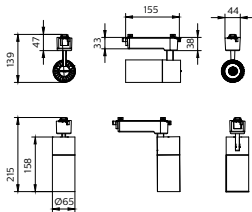

ST033T 20W

ST033T LED17/830 20W 110-240V I MB WH HK

